



- Single Barrel Shotgun  
- Combination Single Barrel Shotgun



READ THE INSTRUCTIONS & WARNINGS IN THIS  
MANUAL CAREFULLY BEFORE USING THIS FIREARM

# ABOUT US

Aksay Av Tüfeği Silah Sanayi ve Ticaret Ltd. Şti was founded in 1991 in Huğlu/Beyşehir is the district of Konya, Turkey. Besides machinery technologies and milling strategies, we are one of the first company in shotgun industry specifically spare parts production. Our story was started with manuel milling and lathe machines. Aksay Silah, day by day, were improved their machinery line with CNC machines. Today Aksay Silah is continuining their production with brandnew cnc machines and professional team.

With our 30 years of experience and newest technology investments, we are focusing on high quality production and non-stop business flow.

Aksay Silah meet, the shotguns industry's need with high quality production and special shotguns. Aksay shotguns fundamentals has not only depends on production technology but also durability, and design.

Shotguns that we produced, are not including only the design and R&D process. Our high experience of spare part production has make us more sharp about details. Details are the main perspective of Aksay Silah. From front sight to buttstock our guns knit by experienced gunsmiths. Machinery's technology and gunsmiths hand crafts create a perfect design and flawless satisfaction.

**SAFE GUN HANDLING IS YOUR OWN RESPONSIBILITY AT ALL TIMES. DISREGARDING WARNINGS IN THIS MANUAL MAY RESULT IN INJURY OR DEATH TO YOU AND OTHERS. ALWAYS HANDLE AND TREAT YOUR GUN AS IF IT WERE LOADED. ALWAYS KEEP THE BARREL POINTED IN A SAFE DIRECTION.**

## PURCHASER'S RECORD

Model # \_\_\_\_\_

Purchase Date: \_\_\_\_\_

Gauge/Caliber: \_\_\_\_\_

Serial #: \_\_\_\_\_

Purchase Price: \_\_\_\_\_

Store Name: \_\_\_\_\_



# SAFETY RULES

1. Read the instructions carefully before use. Reading the manual and careful examination of the firearm are fundamental to avoid any kind of problem.
2. Be aware that you are handling a firearm; therefore your knowledge and behavior may affect your life and those of the people close to you.
3. Firearms and ammunitions must be kept in separate places.
4. Always keep firearm and ammunitions out of reach of children.
5. Store the firearm in a clean, dry and airy place after use to avoid rust in mechanical parts that may cause serious problems in functioning after a period of inactivity.
6. The firearm must always be stored unloaded, always check that the chamber is empty.
7. Keep away from open flames or heating sources.
8. Never leave a loaded firearm unattended.
9. Never leave the firearm loaded, it could fall and cause injury and death. Always point the firearm in a safe direction, and handle it as though it were loaded. This is especially important when loading and unloading the firearm and when handing it to someone else. Never take someone's word that it is unloaded. Always make sure the firearm is unloaded before laying it down or handing it to someone else.
10. After use, clean and lubricate the inside of the barrel with appropriate oil. Grease or oil build up can cause excessive pressure and result in serious personal injuries. Before using the firearm again, inspect the barrel and chamber to make certain that there are no obstructions in the bore. Remove any oil residue with rod and dry patch before shooting.
11. Accumulation of rust in the barrel can cause excessive pressures resulting in serious injury and may cause the explosion of the barrel. A rusted, pitted or eroded barrel should be replaced.
12. Before shooting always check to ensure that the barrel is free of obstructions.
13. Never force a jammed action, this act could cause explosion of the round and consequent injury.
14. Use factory loaded ammunition of the caliber specified on the fire arm barrel. Use of different calibers may cause serious personal injuries to you and to people close to you.
15. **In case of misfire, manually extract the cartridge from the chamber. If firearm fails to fire when trigger is pulled, as a result of slow primer ignition (hang fire), keep muzzle pointed downrange for a minimum of 30 seconds.** If the round does not fire, remove the magazine, clear the firearm and examine the ejected, unfired cartridge. If the indent from the firing pin is off center, light or absent, take the gun to a competent gunsmith. If the indent appears normal compared to other rounds, assume a faulty round, separate from other cartridges, reload and continue shooting.
16. Do not attempt to re-use unexploded ammunitions.
17. Never modify any parts of your firearm. Any alteration may cause serious personal injury and voids the warranty.
18. Only a qualified gunsmith may service the firearm for repair or serious maintenance.
19. Pay great attention during transportation and use. Mechanical safety devices can fail. Developing intelligent, good safety habits is the best way to prevent accidents.
20. Keep the safety "on" or in safe position at all times until you are ready to shot. Do not rely on your gun's safety, the safety on any gun is a mechanical device and is not intended as a substitute for common sense or safe gun handling.
21. Keep your finger off the trigger while operating the action and at all other times until you are ready to shot.



# IDENTIFYING MARKINGS

Every gun we produce has a serial number that is marked on the receiver/frame. Close to the serial number you will also find the manufacturer's information with the model name and caliber marked either on the frame or the slide as required by law.

These markings must not be removed from the firearm for any reason.

## NOMENCLATURE



## OPERATING INSTRUCTIONS

**⚠ WARNING:** Read and understand all instructions and warnings in this manual BEFORE using this shotgun. It is important to learn the parts of your shotgun and their functions before using this firearm.

### Break Open Lever

The Break Open Lever is located in front of the trigger guard and controls the locking of the breech of the barrel to the receiver. To open the gun, pull the Break Open Lever fully rearward and ease down the barrel.

Note: Pulling the Break Open Lever partially rearward will not disengage the locking of the breech. The Break Open Lever may appear to be pulled back fully rearward, but is not. Pulling the Break Open Lever slightly further will fully disengage the locking of the breech.

Do not forget to check your break open lever when closed the gun for shooting. **If the break open lever do not on proper position make push to the barrel to complete locking of the barrel breech.** "Picture 1" is showing how break open lever should be seen before shooting.



Picture 1

### Safety Button

The safety button is located on the upper side of the receiver and must be manually moved to the desired position by the shooter.

Until ready to shot keep your safety button in "on" position. Do not rely solely on your gun's safety. **Treat every gun as if it is loaded and ready to fire.** The safety is a mechanical device and is not intended to serve as a substitute for common sense or safe gun handling. Always keep the muzzle pointed in a safe direction.

**⚠ WARNING:** Do not rely solely on your gun's safety. Treat every gun as if it is loaded and ready to fire. The safety is a mechanical device and is not intended to serve as a substitute for common sense or safe gun handling. Always keep the muzzle pointed in a safe direction.



## Extractor

This gun is equipped with an extractor. Once the Break Open Lever is pulled fully rearward and the action is opened, the extractor will partially elevate both fired and unfired shells in the chamber for easy removal by hand.

## Ammunition

Be sure you have an are using the proper ammunition. Use only high quality ammunition specifically designed for your gauge of shotgun. The barrel is marked with the size of the shot shell it will accept. If the barrel is marked "3" it will accept 3" and 2-3/4" shot shells. Never load chamber with a shell that is longer the chamber is marked.

**⚠ WARNING: DO NOT SHOT STEEL SHOTS WITH YOUR GUN UNLESS USING PROPER CHOKES.**

## Loading

**⚠ WARNING: Read and understand all instructions and warnings in this manual BEFORE using this shotgun. It is important to learn the parts of your shotgun and their functions before using this firearm.**

To load your single barrel shotgun, be sure the safety is in the "safe" or "on" position, pull the Break Open Lever fully rearward and open the action. This will cause the lock to disengage and allow the barrel to pivot downward exposing the chamber. Insert shot shell of the appropriate gauge and size into the chamber. When you are finished loading the chamber, close the breech by lifting up on the barrel and close the action. The Break Open Lever will make an audible "click" when the breech is closed and locked.

Do not forget to check your break open lever when closed the gun for shooting. If the break open lever do not on proper position make push to the barrel to complete locking of the barrel breech.

## Firing

After inserting the shot shell into the chamber, close and lock the breech. Your shotgun is ready to fire. Disengage the safety by pushing the safety button to the "fire" or "off" position, the safety button must be pushed from the back side so that it moves all the way to the front. The button must always be pushed fully to the back position until it moves no further to be in the "fire" or "off" position.

Pulling the trigger through its full travel to the rear will fire the shotgun and discharge the shell.

**⚠ CAUTION : In case of a misfire, wait at least 30 seconds while keeping the gun pointed in a safe direction. Then, carefully open the action away from yourself and others. If the primer on the rim is indented, the shell should be discarded in a manner that would prevent accidental injury to your and/or those-around you.**

## Unloading

Before unloading, check to assure that the safety is in the "safe" or "on" position. At no time during unloading should you allow your fingers or any other object to touch the trigger. Next, pull the Break Open Lever fully rearward and open the action. Pulling the barrel downward fully will partially elevate any fired or unfired shell in the chamber for easy removal by hand.

Inspect the barrel to prevent any obstacle in the barrel for another shots.



# COMBO MODEL BARREL CHANGING INSTRUCTIONS

**⚠ WARNING:** Combination shotguns are produced by gunsmiths for using only same serial number pairs. Please do not use disparate serial number items for combination. When different serial numbers will assembly they do not fit properly to receiver or barrel. This inappropriate assembly may result injury or death.

DISREGARDING WARNINGS IN THIS MANUAL MAY RESULT IN INJURY OR DEATH TO YOU AND OTHERS.

- 1) **Firstly unloaded gun and pull safety in “on” position.**
- 2) Pull the Break Open Lever fully rearward and open the barrel breech.
- 3) Disassemble the handguard’s fore-end sling swivel.
- 4) Press down to fore-end to take of.
- 5) **FIRST STEP:**  
Put your shotgun on the table and unscrew the main connection pin’s screw which is **LEFT SIDE** of the gun with the help of a screw driver. **“Picture 2”**

Warning: Put your shotgun on a table while this process otherwise your walnut stock might be damaged or cracked. This fault is not covered by Warranty.

**SECONDLY:** UNSCREW THE MAIN CONNECTION PIN FROM **RIGHT SIDE** OF THE GUN **“Picture 3”**

WHEN MAIN CONNECTION PIN AND MAIN SCREW’S UNSCREWED YOUR GUN WILL BE READY FOR DISASSEMBLING..

- 6) Take out your barrel from receiver. While this process do not lose the Ejector Sear. It is the main part of extraction of your shot shells. If it will not gathering properly your shotgun will not extract the empty shells.
- 7) Prepare your spare barrel for assembling. Unscrew the fore-end swivel and take out the fore-end.



Picture 2



Picture 3



# COMBO MODEL BARREL CHANGING INSTRUCTIONS

- 8) Put your Ejector sear on the bottom of barrel head properly. **"Picture 4"**
- 9) **Gather barrel and receiver in same position and insert the main connection pin from the LEFT SIDE of the receiver. "Picture 5"**

**SCREW THE MAIN CONNECTION PIN UNTIL THE FINAL POINT AND TIGHTEN MIDDLE HARD.**

10) After complete assembling of main connection pin from RIGHT SIDE of the gun, screw the main screw from RIGHT side. While assembling the main screw do not make it too tighter. If it may too tight, opening and breaking of the gun will be tough and it will not recommended. Try to catch better position according to action of the gun. The better position is, your gun will not fall down directly when you open the break open lever fully.

11) Put fore-end to end of the barrel head and push to barrel.

12) Assemble the fore-end sling swivel properly.

13) **Close the shotgun hardly and check the Break Open Lever for the control of the locking the barrel breach. Break open lever needs to complete the movement from the trigger guard to barrel. If it completed the action it locked properly. "Picture 6"**

14) READY TO SHOOT.

**ASSEMBLING VIDEO HAS UPLOADED BY AKSAY SILAH ON YOUTUBE CHANNEL.**

**WARNING: DO NOT FORGET TO PUT MAIN CONNECTION PIN AND MAKE TIGHT OF MAIN SCREW. OTHERWISE, IT MAY RESULT INJURY OR DEATH. MAIN CONNECTION PIN IS THE MOST IMPORTANT PART OF THE CONNECTION BETWEEN BARREL BREECH AND RECEIVER. DO NOT MAKE ANY FAULT OF THIS PROCESS. IF HAVE ANY QUESTION OR DOUBT ABOUT ASSEMBLY DO NOT HESITATE TO SEND E-MAIL TO AKSAY SILAH FROM [info@aksaysilah.com](mailto:info@aksaysilah.com).**

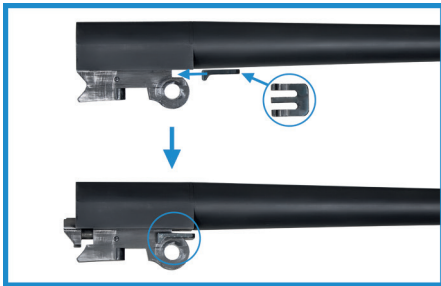

Picture 4



Picture 5



Picture 6



## REVOLUTION ARMORY



#100- 24787, 117 Avenue  
Acheson, AB  
T7X 6C2 CANADA



1-780-960-0418



info@revolutionarmory.com

[www.revolutionarmory.com](http://www.revolutionarmory.com)